

PLOTTED BY: ANDREW DEVLIN DATE: Tuesday, November 23, 2021

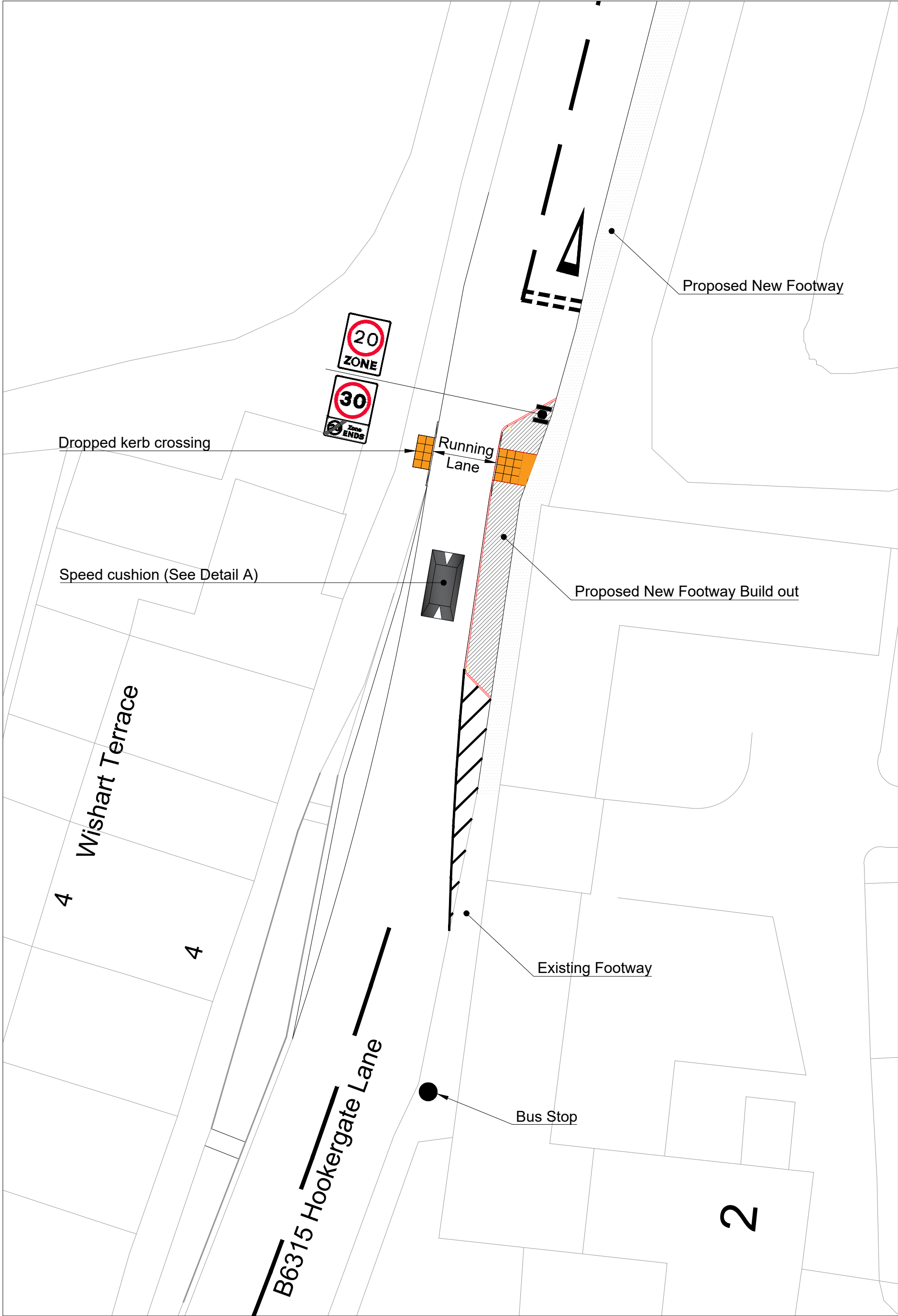

Scale 1:200

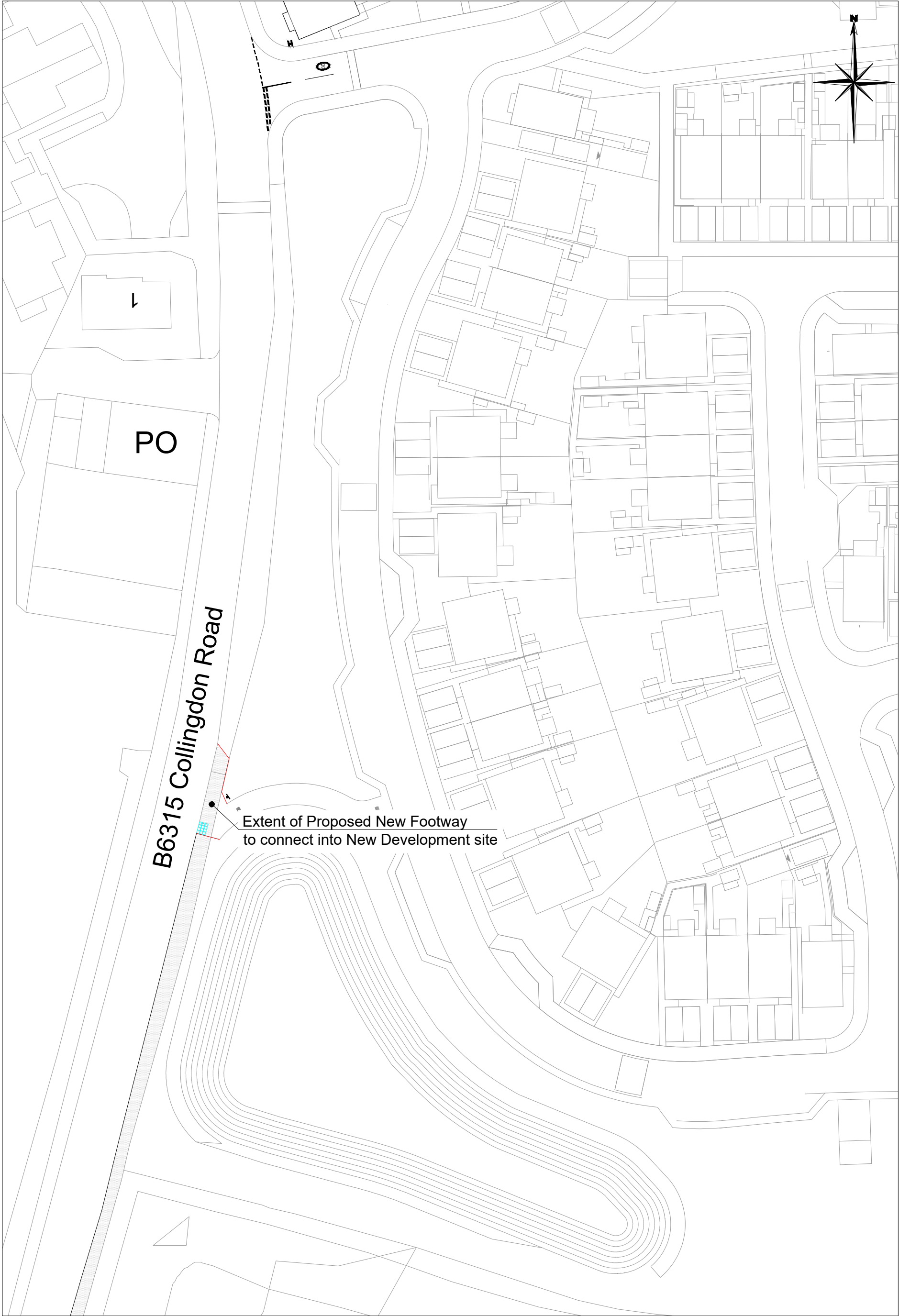

Scale 1:500

NOTES :-  
 1. All setting out to be agreed by Engineer on site.

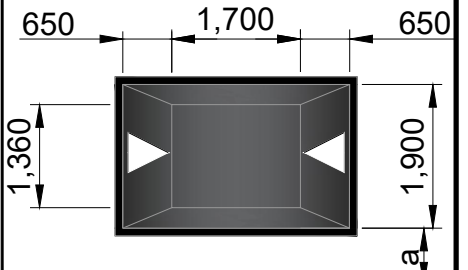

Detail A  
 Scale 1:200

CONSULTATION

DO NOT SCALE FROM DRAWING  
 Where shown, utilities plant information is indicative only. The accuracy thereof cannot be guaranteed and all information must be verified by the contractor with the statutory undertakers.  
 This map is reproduced from Ordnance Survey material with the permission of Ordnance Survey on behalf of the Controller of Her Majesty's Stationery Office © Crown copyright. Unauthorised reproduction infringes Crown copyright and may lead to prosecution or civil proceedings.  
 Gateshead Council [O.S. license No 100019132] 2008

| Rev | Date | Amendments | Prepared | Checked | Approved |
|-----|------|------------|----------|---------|----------|
| --- | ---  | ---        | ---      | ---     | ---      |

**Gateshead Council**

City Centre  
Regent Street  
Gateshead, NE8 1HT  
Tel: 0191 4333000  
www.gateshead.gov.uk

Highways & Waste  
Trevor Waggett B.Eng (Hons), MCIHT, FIHE  
Engineering Services Manager

CLIENT:-  
Gateshead Council

SCHEME NAME:-  
High Spen / Glossop Street

DRAWING TITLE:-  
Section 106  
Informal Consultation

PREPARED BY:-  
A.Devlin

CHECKED BY:-  
N.Frier

APPROVED BY:-  
T.Waggett

DATE:-  
08/11/21

SCALES:-  
As Noted

DRAWING NO:-  
TS\_0548-001

REV